



FACULTY OF GEOGRAPHY
LOMONOSOV
MOSCOW STATE UNIVERSITY

THE EUROPEAN REGIONAL
SCIENCE ASSOCIATION (ERSA)
RUSSIAN SECTION



Nov 20-21

Moscow | Online (Zoom)

Online conference

«The World in COVID-19: The Impact of the Pandemic on the Development of Countries and Regions»

21 November, Saturday

Session 2. The impact of the pandemic on development of foreign countries and regions: lessons for Russia (I. Vitver and V. Volsky memorial scientific readings)

11.40-12.00

Federico Camerin, The University of Valladolid

The Barcelona's Superblock as a measure to deal with the impact of the pandemic at a neighborhood scale. Lessons learnt for Russia

Introduction

The concept of Superblock

The case study context

Poblenou's Superblock implementation: a game changer in contrast to the pandemic outbreak impacts?

Open debate between pandemic, urban design, planning and pandemic outbreak and lessons learnt from Superblocks experience

Introduction

Ecology. Urban Planning, Infrastructures and Mobility



Home / What we do and why / Citizens' commitment / Citizen Commitment to Sustainability – a More Sustainable Barcelona

Citizen Commitment to Sustainability – a More Sustainable Barcelona

In December 2012, more than 800 institutions, professional associations, unions, trade unions, universities, schools and businesses signed the 10 goals set by the "Public Commitment towards Sustainability 2012-2022 - Compromís 22". The Commitment sets 10 goals for a more equitable, prosperous and self-sufficient Barcelona, through the involvement, commitment and collaboration of the entities signing the public commitment. It takes over the "Public Commitment towards Sustainability 2002-2012" which reached the end of its term after a career of 10 years of collective work to make Barcelona a more livable, efficient and sustainable city, following 10 major goals and 100 lines of action.

Through the network of signatories, called "For a More Sustainable Barcelona" participation, exchange of information and resources are promoted. It gives projection to the initiatives of the member organizations and promotes collaboration opportunities. "For a more Sustainable Barcelona" Secretariat, sponsored by the city council of Barcelona, offers tailored advice to all members of the network as well as consultation, training, organization of activities and communication tools.



The concept of Superblock

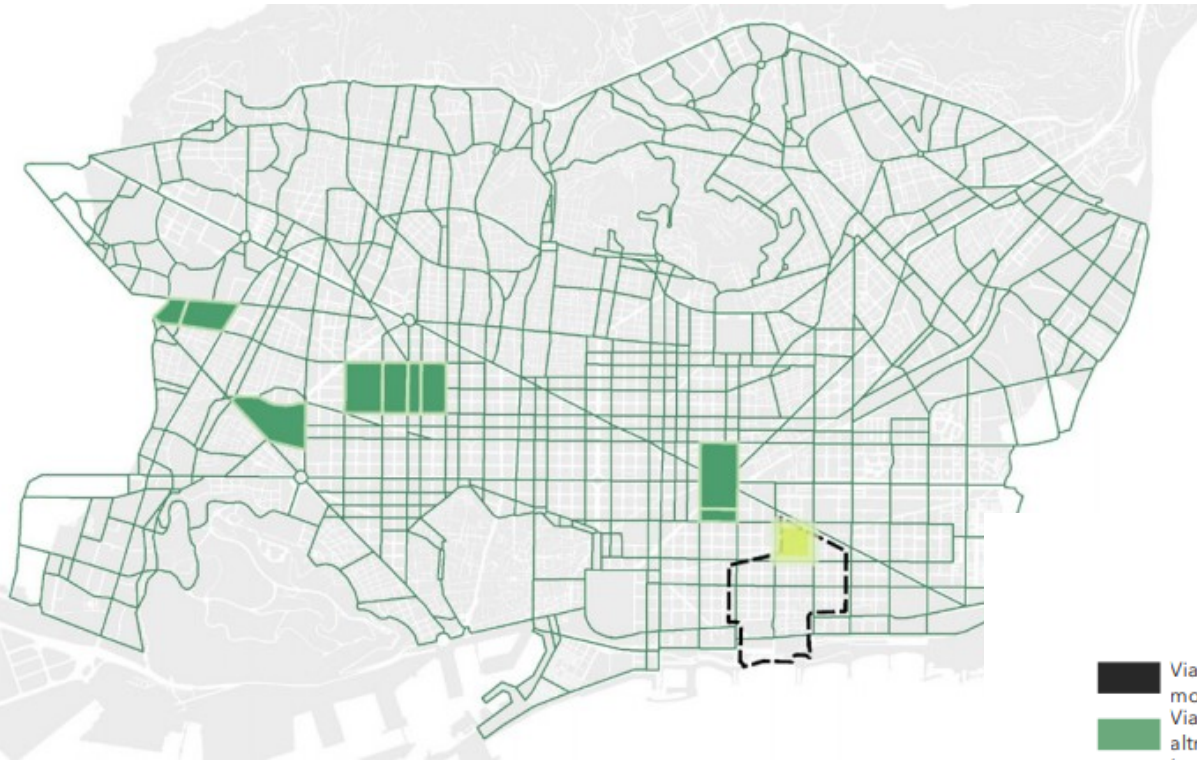

https://ajuntament.barcelona.cat/superilles/sites/default/files/20150217%20%20Diagnostic%20Superilla%20Poblenou%201_0.pdf

- Abatement of private motorised transport by 19.2%
- Bettering air quality and reducing urban noise so as to prevent 667 premature deaths;
- Green surface increase from 2.7 sqm/inhab to 6.3 sqm/inhab in all Extension district area and up to 7.6 sqm/inhab in Sant Martí district;

- Current heat island effect in a 3x3 block would drop of about -35.9%;
- Public space green, blocks' interior patio's green and green surfaces would increase of 35.8%

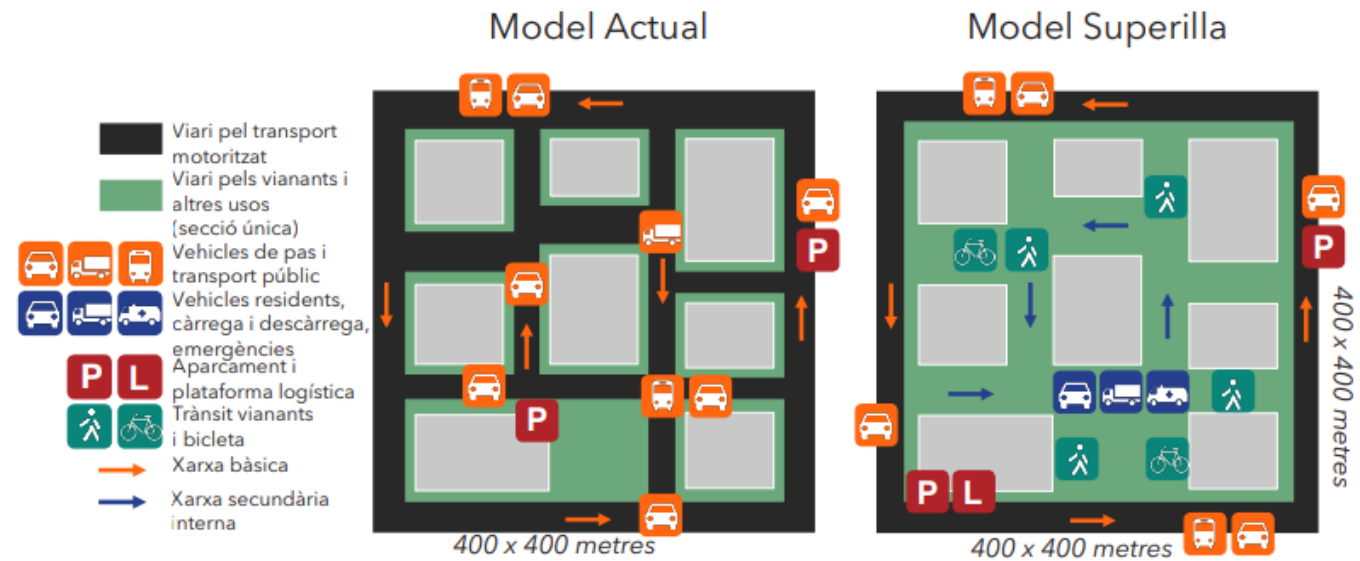

Esquema del model de Superilla. Font: BCNecologia

Source images: Ajuntament de Barcelona, 2016

The case study context

“Neighbourhood unit” comprising Badajoz, Pallars, La Llacuna, and Tànger streets



- Districte de Sant Martí
- Barri del Poblenou
- Superilles
- Superilles pilot



Àmbit Superilles Pilot Barri del Poblenou. Font: BCNecologia



Poblenou (a Catalan word meaning “new village”) in the north-eastern part of Barcelona was a fundamental pillar of Spanish industrialisation

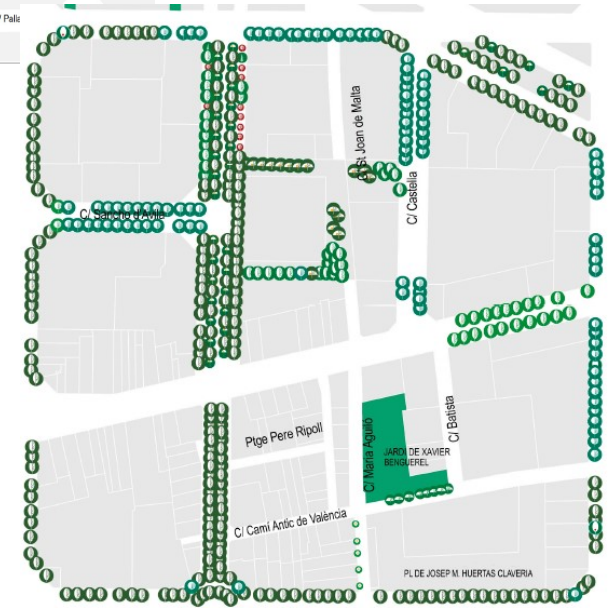

Source images: Ajuntament de Barcelona, 2010 and 2020

Poblenou's Superblock implementation: a game changer in contrast to the pandemic outbreak impacts?

Renewal of the existing built environment

- 13,350 sqm of public spaces to pedestrian use;
- doubling of green spaces and tree-lined street from 9,722 sqm to 18,632 sqm;
- 349 benches;
- decrease of car-parking spaces from 575 to 316,
- growing number of outdoor cultural activities in the new playground areas (2,483 sqm), and 37 new premises for activities at street level

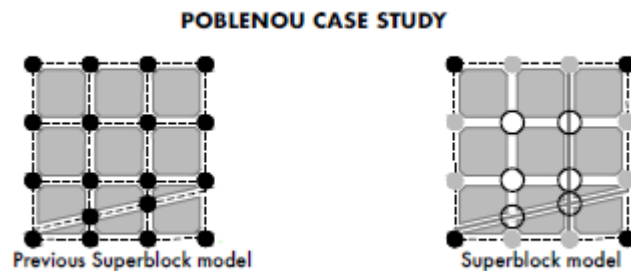
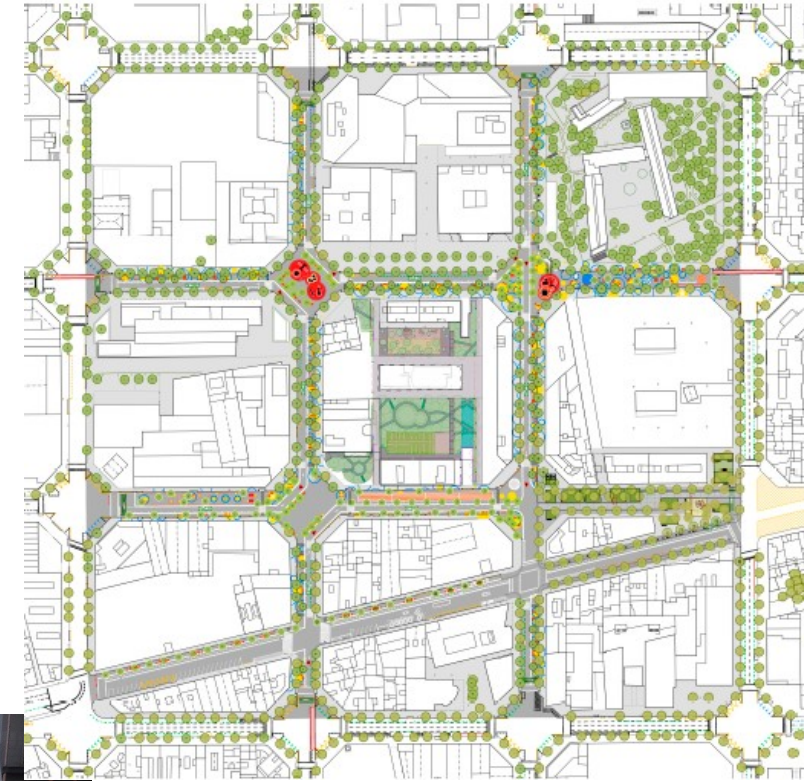

Poblenou's Superblock implementation: a game changer in contrast to the pandemic outbreak impacts?

Impacts and issues

- A better air quality, greener environment, and more spaces for the slow mobility to reduce air pollution and noise and heat waves
- mitigating the negative effects of density in the post-pandemic environment
- market values seem to follow the general real estate trends, unaffected by the Superblock-operated change
- Governance issues in the short, medium and long term
 1. budget availability
 2. lack of open debates with citizens
 3. overlapping of Poblenou unit to the existing built environment



Open debate between pandemic, urban design, planning and pandemic outbreak and lessons learnt from Superblocks experience

- Diverse approaches that shift from the logic of mobility to one of accessibility: 15-minute city (Paris) and 20-minute neighbourhood (Melbourne) along with the concept of tactical urbanism
- Barcelona within Global Mayors COVID-19 Recovery Task Force'

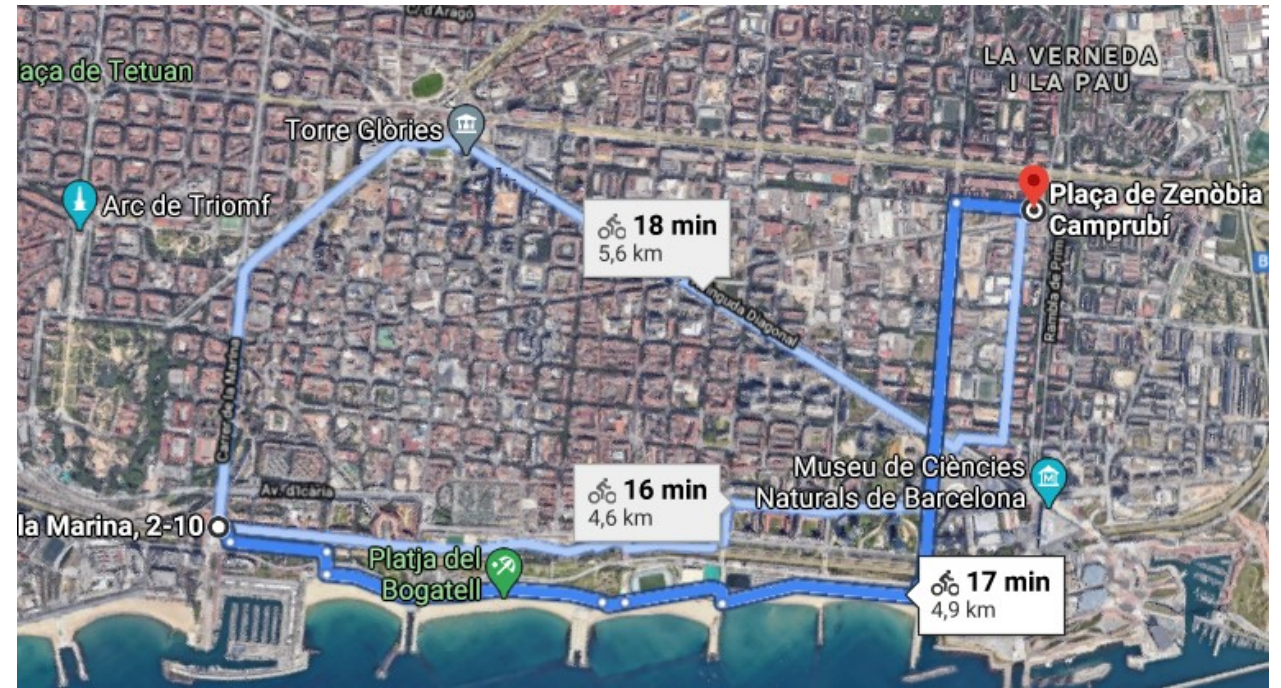

Source: search in Google Maps, 2020

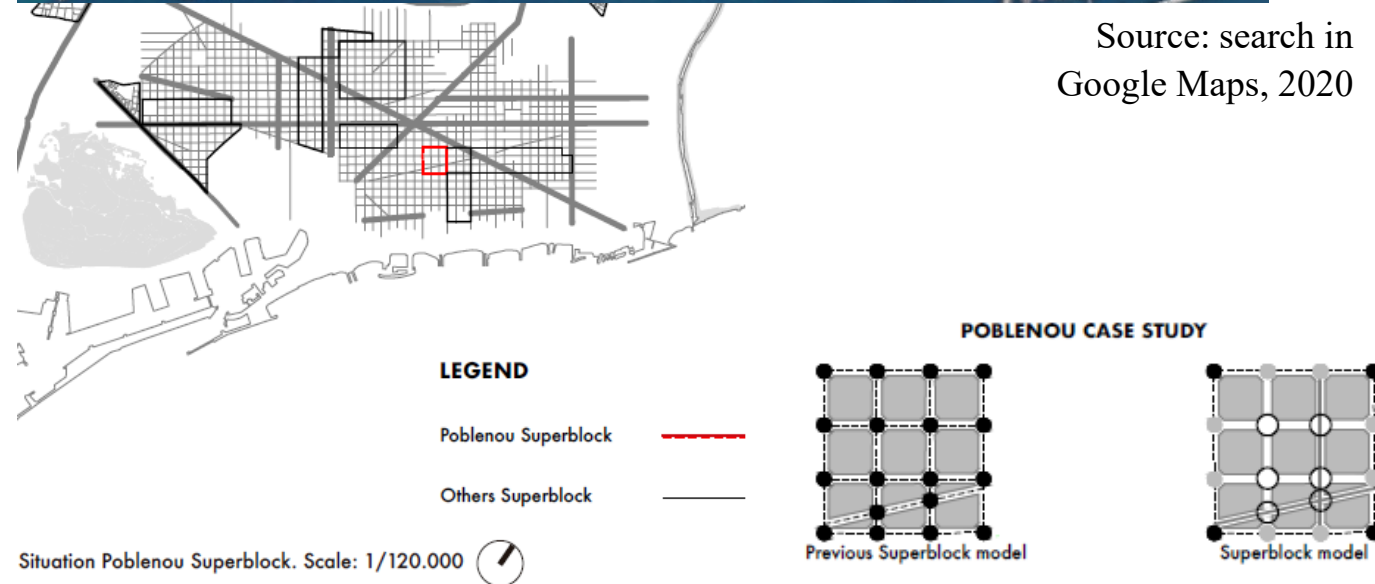

Open debate between pandemic, urban design, planning and pandemic outbreak and lessons learnt from Superblocks experience

- Bottom-up approach with a previous citizens' consultation
- Doubts about the application of this model in cities heavily congested by sprawl and weak regulatory frameworks in both the North and the South of the world
- Gentrification concerns
- The basic principles of Superblocks have undoubtedly countered the negative impact of Covid-19 by making these units more inclusive, resilient, sustainable, and safer



Source: Ajuntament de Barcelona, 2020